



Malleable Iron Pipe Fittings

BS Standard

*To Provide **Safe & Reliable** Products and **Smart & Complete**
Solutions for Clients in Fluid Conveying Industry Across the Globe.*



Phone: +86-18931038098

Web: www.dinsenmetal.com

Email: bill@dinsenpipe.com



More than 60 years of Foundry Experience

Company Profile

DINSEN Group is a high-tech enterprise specializing in the supply of pipe fittings and valves for the fluid industry. The company has won more than 400 awards Single Champion Demonstration Enterprise, Green Manufacturing Enterprise, Top 100 Enterprises of China Light Industry, Leading Enterprise of China Malleable Steel Pipe Fittings Production Base, National Contract-abiding and Credit-honoring Enterprise, China Famous Trademark and other honors.

Inherit originality and pursue excellence. "DS" brand products are widely used in landmark buildings such as Burj Khalifa in Dubai, New World Trade Center in New York, Shanghai Tower, UHV transmission lines, and Beijing-Shanghai high-speed railway projects. Adhere to customer-centric product development and innovation concepts, meet and guide the growing needs of users, provide safe and reliable products and intelligent complete solutions for global fluid industry customers, DINSEN Group has become an industry leader

Relying on the national enterprise technology center, post-doctoral scientific research workstation and other development and innovation platforms, DINSEN Group promotes the transformation of technological innovation achievements into productivity, and completes the transformation of production methods. Processes are moving from mechanization to automation and intelligence, management is moving from experience to institutionalization, and marketing is moving from selling products to providing solutions, steadily improving the position of DINSEN Group in the global value chain.

Through the construction of three major production bases in Jinan, Linyi and Bangkok, DINSEN Group has formed a cross-regional and multi-base international development pattern. DINSEN Group remains true to its original aspiration, operates in compliance with regulations, continues to grow, insists on sharing development results with customers, employees, shareholders, and the society, and strives to become a happy and respected enterprise.

State of the Art Equipment

High-precision equipment is the guarantee of quality. DINSEN's factories are equipped with the most advanced facilities and equipment in the industry. The main production equipment includes Xindong automatic molding line, Tokyu automatic molding line, China 416 automatic vertical molding line, automatic molding sand mixer, cupola, electric furnace, water-cooled longevity cupola, CNC vertical machining center, CNC machine tools, CNC Vertical lathes, radial drilling machines, DINSEN proprietary automatic machine tools, hot-dip galvanizing lines, automatic sealing lines, three-dimensional warehouses, etc.



Pattern



Core Making



Sand Mulling



Melting



Sinto FCMX



DISA



Tokyu AMF-111055



Pouring



Annealing



End Grinding Line



Warehouse



Threading, Air Pressure Test, and Anti-rust Treatment

Reliable Quality Assurance

DINSEN has been rated as a National Enterprise Technology Center and has the ability to conduct a full range of tests and inspections including chemical inspections, etc. Inspection facilities include: spectrometer, carbon-sulfur analyzer, metallographic microscope, tensile testing machine, etc.

Strength testing equipment, pressure testing equipment, adhesion testing equipment, three coordinates, hardness tester, etc. From incoming inspection to finished products, the whole process of quality inspection and monitoring. Every step of the manufacturing process is carefully documented, regularly reviewed for revision control and updating standards. Quality procedures are constantly monitored and updated to ensure that only the highest and most consistent quality products are delivered to our valued customers.



Metallurgical Microscope



Spectrometer

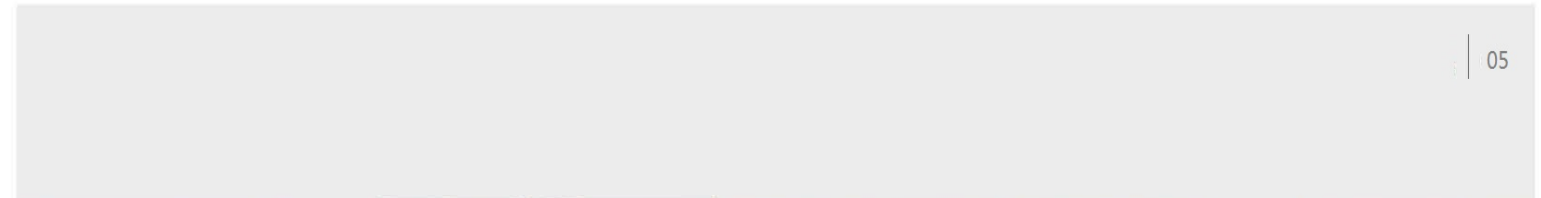

CMM



Projector



The Length of The Test Instrument



Roughness Tester



Carbon Sulfur Analyzer



Tensile Strength Testing Equipment



Sand Testing Instrument



Malleable Iron Pipe Fittings

BS Standard

Material: BS EN 1562
 Dimensions: BS EN 10242
 Threads: ISO 7-1
 Size Available: 1/8"- 6"



1#

Bend 90°, M/F

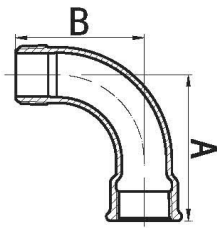

Size	Inch	1/8	1/4	3/8	1/2	3/4	1	1 1/4
	mm	6	8	10	15	20	25	32
Dim. (mm)	A	35	40	48	55	69	85	105
	B	32	36	42	48	60	75	95
Size	Inch	1 1/2	2	2 1/2	3	4	6	
	mm	40	50	65	80	100	150	
Dim. (mm)	A	116	140	176	205	260	365	
	B	105	130	165	190	245	345	

1#F

Bend 90°, M/F

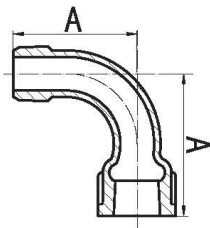

Size	Inch	1/2	3/4	1	1 1/4	1 1/2	2
	mm	15	20	25	32	40	50
Dim. (mm)	A	52	65	82	100	115	140
Size	Inch	2 1/2	3	4			
	mm	65	80	100			
Dim. (mm)	A	175	205	260			

1A

Short Bend 90°, M/F

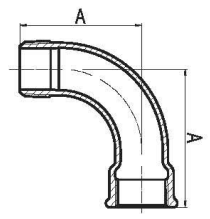

Size	Inch	1/4	3/8	1/2	3/4	1	1 1/4
	mm	8	10	15	20	25	32
Dim. (mm)	A	30	36	45	50	63	76
Size	Inch	1 1/2	2	2 1/2	3	4	
	mm	40	50	65	80	100	
Dim. (mm)	A	85	102	115	138	167	

1AF

Short Bend 90°, M/F

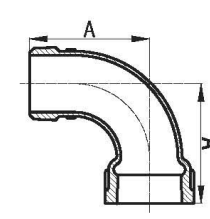

Size	Inch	1/4	3/8	1/2	3/4	1	1 1/4
	mm	8	10	15	20	25	32
Dim. (mm)	A	30	36	45	50	63	76
Size	Inch	1 1/2	2	2 1/2			
	mm	40	50	65			
Dim. (mm)	A	85	102	115			

2#

Bend 90°, female

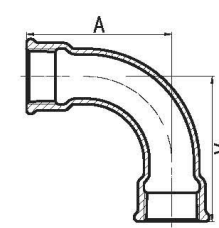

Size	Inch	1/4	3/8	1/2	3/4	1	1 1/4
	mm	8	10	15	20	25	32
Dim. (mm)	A	40	48	55	69	85	105
Size	Inch	1 1/2	2	2 1/2	3	4	
	mm	40	50	65	80	100	
Dim. (mm)	A	116	140	176	205	260	

2A

Short bend 90°, female

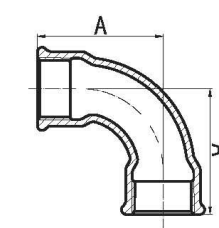

Size	Inch	1/2	3/4	1	1 1/4	1 1/2	2
	mm	15	20	25	32	40	50
Dim. (mm)	A	45	50	63	76	85	102
Size	Inch	2 1/2	3	4			
	mm	65	80	100			
Dim. (mm)	A	115	138	167			

2AF

Short bend 90°, female

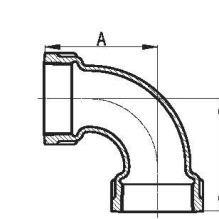

Size	Inch	1/4	3/8	1/2	3/4	1	1 1/4
	mm	8	10	15	20	25	32
Dim. (mm)	A	30	36	45	50	63	76
Size	Inch	1 1/2	2	2 1/2	3		
	mm	40	50	65	80		
Dim. (mm)	A	85	102	113	138		

3#

Bend 90°, male

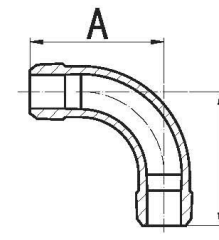

Size	Inch	3/8	1/2	3/4	1	1 1/4	1 1/2
	mm	10	15	20	25	32	40
Dim. (mm)	A	42	48	60	75	95	105
Size	Inch	2	2 1/2	3	4		
	mm	50	65	80	100		
Dim. (mm)	A	130	165	190	245		

40

Bend 45°, M/F

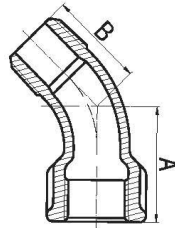

Size	Inch	1/4	3/8	1/2	3/4	1	1 1/4
	mm	8	10	15	20	25	32
Dim. (mm)	A	26	30	36	43	51	64
	B	21	24	30	36	42	54
Size	Inch	1 1/2	2	2 1/2	3	4	6
	mm	40	50	65	80	100	150
Dim. (mm)	A	68	81	99	113	142	197
	B	58	70	86	100	126	176

40F

Bend 45°, M/F

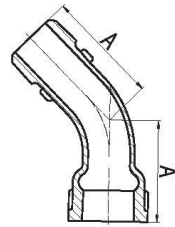

Size	Inch	3/4	1	1 1/4	1 1/2	2	2 1/2
	mm	20	25	32	40	50	65
Dim. (mm)	A	45	55	68	70	85	100
	B						
Size	Inch	3	4				
	mm	80	100				
Dim. (mm)	A	115	145				
	B						

41

Bend 45°, female

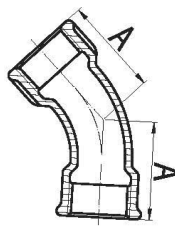

Size	Inch	1/4	3/8	1/2	3/4	1	1 1/4
	mm	8	10	15	20	25	32
Dim. (mm)	A	26	30	36	43	51	64
	B						
Size	Inch	1 1/2	2	2 1/2	3	4	6
	mm	40	50	65	80	100	150
Dim. (mm)	A	68	81	99	113	142	197
	B						

85

Crossover

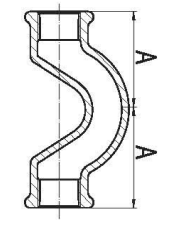

Size	Inch	1/2	3/4	1	1 1/4	1 1/2	2
	mm	15	20	25	32	40	50
Dim. (mm)	A	45	54	70	91	100.5	115
	B						
Size	Inch						
	mm						
Dim. (mm)	A						
	B						

90

Elbow, 90°

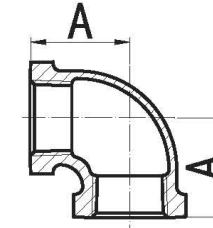

Size	Inch	1/8	1/4	3/8	1/2	3/4	1	1 1/4
	mm	6	8	10	15	20	25	32
Dim. (mm)	A	19	21	25	28	33	38	45
	B							
Size	Inch	1 1/2	2	2 1/2	3	4	5	6
	mm	40	50	65	80	100	125	150
Dim. (mm)	A	50	58	69	78	96	115	131
	B							

90R

Reducing Elbow, 90°

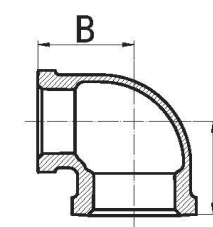

Size	Inch	4X1 1/4	4X1 1/2	4X2	4X2 1/2	4X3
	mm	100X32	100X40	100X50	100X65	100X80
Dim. (mm)	A	60	62	68	77	82
	B	85	85	86	89	90
Size	Inch	3/4X1/2	1X1/4	1X3/8	1X1/2	1X3/4
	mm	20X15	25X8	25X10	25X15	25X20
Dim. (mm)	A	30	27	30	32	35
	B	31	31	32	34	36

90R

Reducing Elbow, 90°

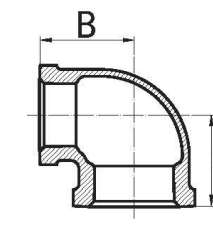

Size	Inch	3/8X1/8	3/8X1/4	6X4	1/2X1/4	1/2X3/8
	mm	10X6	10X8	150X100	15X8	15X10
Dim. (mm)	A	20.5	23	102	24	26
	B	21.5	23	125	24	26
Size	Inch	1 1/4X3/8	1 1/4X1/2	1 1/4X3/4	1 1/4X1	1 1/2X1/2
	mm	32X10	32X15	32X20	32X25	40X15
Dim. (mm)	A	32	32	36	40	34
	B	36.5	37	41	42	41

90R

Reducing Elbow, 90°

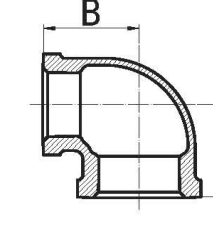

Size	Inch	3/4X1/4	3/4X3/8	1 1/2X1 1/4	2X1/2	2X3/4
	mm	20X8	20X10	40X32	50X15	50X20
Dim. (mm)	A	26	28	46	35	40
	B	27	28	48	47	48
Size	Inch	1 1/2X3/4	1 1/2X1	3X1	3X1 1/4	3X1 1/2
	mm	40X20	40X25	80X25	80X32	80X40
Dim. (mm)	A	37	42	50	53.5	56
	B	42	46	68	68	69

90R

Reducing Elbow, 90°

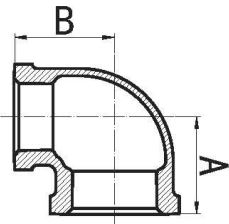

Size	Inch	2X1	2X1 1/4	2X1 1/2	2 1/2 X 3/4	2 1/2 X 1	2 1/2 X 2
	mm	50X25	50X32	50X40	65X20	65X25	65X50
Dim. (mm)	A	43	47	52	42.5	46.5	61
	B	50	53	56	57	58.5	66
Size	Inch	3X2	3X2 1/2	1 1/4 X 1/8	2 1/2 X 1 1/4	2 1/2 X 1 1/2	3X3/4
	mm	80X50	80X65	8X6	65X32	65X40	80X20
Dim. (mm)	A	60.5	71	18.5	50.5	53.5	45
	B	71	74	19	60	61	65

92

Street Elbow, 90°

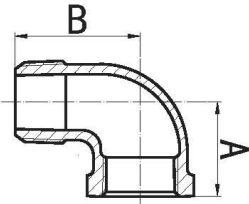

Size	Inch	1/8	1/4	3/8	1/2	3/4	1	1 1/4
	mm	6	8	10	15	20	25	32
Dim. (mm)	A	19	21	25	28	33	38	45
	B	25	28	32	37	43	52	60
Size	Inch	1 1/2	2	2 1/2	3	4	6	
	mm	40	50	65	80	100	150	
Dim. (mm)	A	50	58	69	78	96	127.5	
	B	65	74	88	98	118	202	

92R

Reducing Street Elbow, 90°

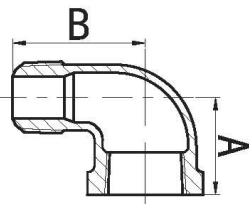

Size	Inch	3/4 X 1/2	1 X 3/4				
	mm	20X15	25X20				
Dim. (mm)	A	30	35				
	B	65.4	46				
Size	Inch						
	mm						
Dim. (mm)	A						
	B						

95

Union Elbow F/F

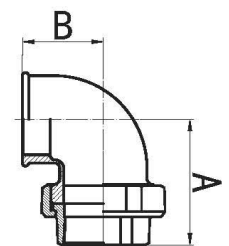

Size	Inch	1/2	3/4	1	1 1/4	1 1/2	2
	mm	15	20	25	32	40	50
Dim. (mm)	A	28	33	38	45	50	58
	B	58	62	72	82	90	100
Size	Inch						
	mm						
Dim. (mm)	A						
	B						

96

Union Elbow F/F

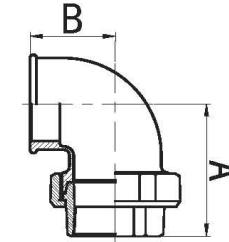

Size	Inch	1/2	3/4	1	1 1/4	1 1/2	2
	mm	15	20	25	32	40	50
Dim. (mm)	A	58	62	72	82	90	100
	B	28	33	38	45	50	58
Size	Inch						
	mm						
Dim. (mm)	A						
	B						

97

Union Elbow M/F

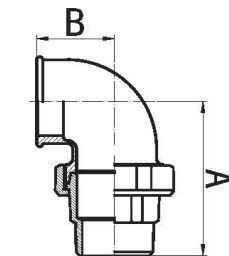

Size	Inch	1 1/2					
	mm	40					
Dim. (mm)	A	128					
	B	58					
Size	Inch						
	mm						
Dim. (mm)	A						
	B						

98

Union Elbow M/F

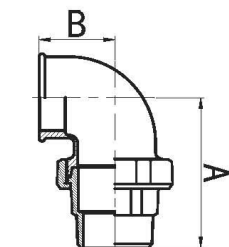

Size	Inch	1/2	3/4	1	1 1/4	1 1/2	
	mm	15	20	25	32	40	
Dim. (mm)	A	76	82	94	107	115	
	B	28	33	38	45	50	
Size	Inch						
	mm						
Dim. (mm)	A						
	B						

120

Elbow, 45°

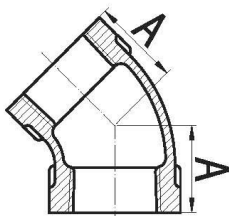

Size	Inch	1/8	1/4	3/8	1/2	3/4	1	1 1/4
	mm	6	8	10	15	20	25	32
Dim. (mm)	A	16	18.5	20	22	25	28	33
	B							
Size	Inch	1 1/2	2	2 1/2	3	4	5	6
	mm	40	50	65	80	100	125	150
Dim. (mm)	A	50	58	69	78	96	77.5	86
	B							

121

Street Elbow, 45°

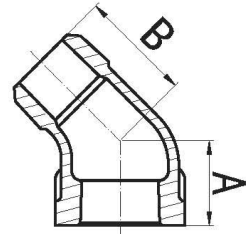

Size	Inch	1/8	1/4	3/8	1/2	3/4	1
	mm	6	8	10	15	20	25
Dim. (mm)	A	16	18.5	20	22	25	28
	B	21	24	25	28	32	37
Size	Inch	1 1/4	1 1/2	2	2 1/2	3	4
	mm	32	40	50	65	80	100
Dim. (mm)	A	33	36	43	49.5	55	66
	B	43	46	55	65	76	94

130

Tee

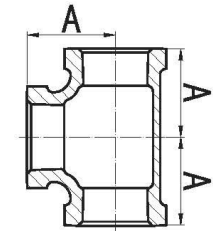

Size	Inch	1/8	1/4	3/8	1/2	3/4	1	1 1/4
	mm	6	8	10	15	20	25	32
Dim. (mm)	A	19	21	25	28	33	38	45
Size	Inch	1 1/2	2	2 1/2	3	4	5	6
	mm	40	50	65	80	100	125	150
Dim. (mm)	A	50	58	69	78	96	115	131

130R

Reducing Tee

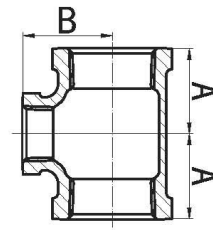

Size	Inch	4X1/2	4X3/4	4X1	4X1 1/4	4X1 1/2
	mm	100X15	100X20	100X25	100X32	100X40
Dim. (mm)	A	50	53	56	60	61
	B	79	79	81	84	84
Size	Inch	1 1/2X1 1/8	1 1/2X1 1/4	1 1/2X3/8	3/4X1 1/4	3/4X3/8
	mm	15X6	15X8	15X10	20X8	20X10
Dim. (mm)	A	22	24	26	26	28
	B	23	24	26	27	28

130R

Reducing Tee

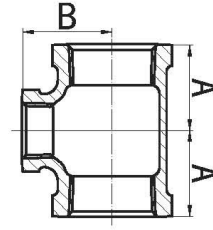

Size	Inch	4X2	4X2 1/2	4X3	3/8X1 1/4	6X4
	mm	100X50	100X65	100X80	10X8	150X100
Dim. (mm)	A	70	84	82	22	105
	B	86	92	90	22.5	125.5
Size	Inch	3/4X1 1/2	1X1/4	1X3/8	1X1/2	1X3/4
	mm	20X15	25X8	25X10	25X15	25X20
Dim. (mm)	A	30	28	30	32	35
	B	31	31	32	34	36

130R

Reducing Tee

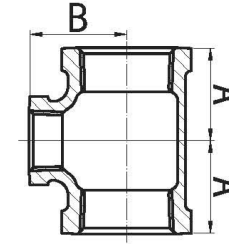

Size	Inch	6X2	6X3	1 1/4X3/4	1 1/4X1	1 1/2X3/8
	mm	150X50	150X80	32X20	32X25	40X10
Dim. (mm)	A	75	92.5	36	40	34
	B	115	120.5	41	42	39
Size	Inch	1 1/4X3/8	1 1/4X1/2	2X1 1/2	2 1/2X1 1/2	2 1/2X3/4
	mm	32X10	32X15	50X40	65X15	65X20
Dim. (mm)	A	32	34	52	40	43
	B	36	38	55	56	57

130R

Reducing Tee

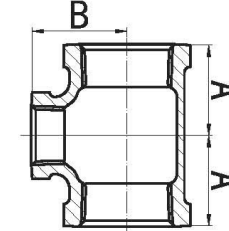

Size	Inch	1 1/2X1/2	1 1/2X3/4	1 1/2X1	1 1/2X1 1/4	2X3/8
	mm	40X15	40X20	40X25	40X32	50X10
Dim. (mm)	A	36	38	42	46	36
	B	42	44	46	48	46
Size	Inch	2 1/2X1	2 1/2X1 1/4	2 1/2X1 1/2	2 1/2X2	3X1/2
	mm	65X25	65X32	65X40	65X50	80X15
Dim. (mm)	A	47	52	55	61	42
	B	60	62	63	66	64

130R

Reducing Tee

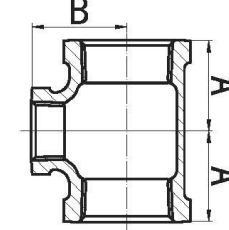

Size	Inch	2X1/2	2X3/4	2X1	2X1 1/4	3X2	3X3/4
	mm	50X15	50X20	50X25	50X32	80X50	80X20
Dim. (mm)	A	38	40	44	48	64	45
	B	48	50	52	54	73	65
Size	Inch	3X1	3X1 1/4	3X1 1/2	3X2 1/2	1 1/4X1/8	
	mm	80X25	80X32	80X40	80X65	8X6	
Dim. (mm)	A	51	55	58	72	18.5	
	B	67	70	71	76	19	

130R

Reducing Tee

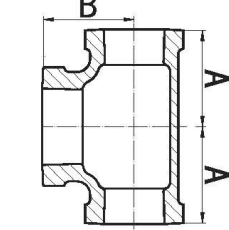

Size	Inch	1 1/2X1 1/2X3/4	1 1/2X1 1/2X1	3/4X3/4X1	3/4X3/4X1 1/4
	mm	15X15X20	15X15X25	20X20X25	20X20X32
Dim. (mm)	A	31	34	36	41
	B	30	32	35	36
Size	Inch	1X1X2	1X1X2 1/2	1 1/4X1 1/4X1 1/2	1 1/4X1 1/4X2
	mm	25X25X50	25X25X65	32X32X40	32X32X50
Dim. (mm)	A	51	60	48	54
	B	48.5	48	46	48

130R

Reducing Tee

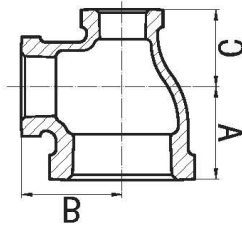

Size	Inch	1 1/2X1 1/4X2	2X1 1/2X1 1/2	2X1 1/2X3/4	2X1 1/2X1	2X1 1/2X1 1/4
	mm	40X32X60	50X40X15	50X40X20	60X40X25	60X40X32
Dim. (mm)	A	55	38	40	44	48
	B	51.5	48	50	52	54
	C	53.5	36	39	42	46
Size	Inch	2 1/2X2X1 1/2	2 1/2X2X1	2 1/2X2X1 1/4	3X2 1/2X2	
	mm	65X50X15	65X50X25	65X50X32	80X65X50	
Dim. (mm)	A	57	53	57	67	
	B	64	60	64	74.5	
	C	52	53	52	64	

131

Pitcher Tee

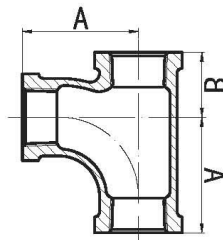

Size	Inch	1/2	3/4	1	1 1/4	1 1/2	2
	mm	15	20	25	32	40	50
Dim. (mm)	A	45	50	63	76	85	102
	B	24	28	33	40	43	53
Size	Inch						
	mm						
Dim. (mm)	A						
	B						

131R

Reducing Pitcher Tee

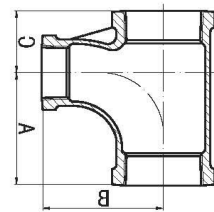

Size	Inch	3/4X1/2	1X1/2	1X3/4	1X3/4X3/4
	mm	20X15	25X15	25X20	25X20X20
Dim. (mm)	A	47	49	53	53
	B	48	51	54	54
	C	25	28	30	28
Size	Inch	1 1/4X1/2	1 1/4X3/4	1 1/2X3/4	1 1/2X1
	mm	32X15	32X20	40X20	40X25
Dim. (mm)	A	51	55	55	66
	B	56	58	61	71
	C	30	33	33	36

134

Service Tee

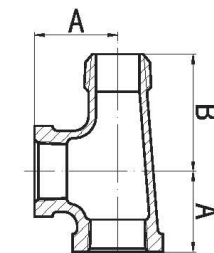

Size	Inch	1/2	3/4	1	1 1/4	1 1/2	2
	mm	15	20	25	32	40	50
Dim. (mm)	A	28.5	33.5	38	44.5	49.5	57
	B	41.5	48	54.5	62	68.5	83
Size	Inch						
	mm						
Dim. (mm)	A						
	B						

134R

Reducing Service Tee

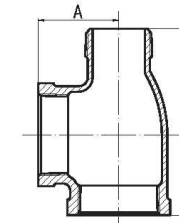

Size	Inch	2X1 1/4	2 1/2X2	3X2 1/2		
	mm	50X40	65X50	80X65		
Dim. (mm)	A	57	69	78		
	B	75	88	106		
Size	Inch					
	mm					
Dim. (mm)	A					
	B					

137RL

Water Knockout Drum

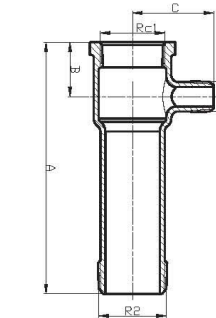

Size	Inch	1 1/2X1/2	1 1/2X3/4X9.45	1 1/2X3/4X9.45
	mm	40X15	40X15X240	40X20X240
Dim. (mm)	A	220 ± 3.5	240 ± 3.5	240 ± 3.5
	B	38 ± 2.0	38 ± 2.0	38 ± 2.0
	C	58 ± 2.5	58 ± 2.5	58 ± 2.5
	Rc1	Rc 1 1/2	Rc 1 1/2	Rc 1 1/2
	R2	R 1 1/2	R 1 1/2	R 1 1/2
	R3	R 1/2	R 1/2	R 3/4

165

Lateral Y Branche, 45°

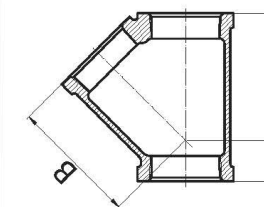

Size	Inch	1/2	3/4	1	1 1/4	1 1/2	2
	mm	15	20	25	32	40	50
Dim. (mm)	A	15.5	18.3	21.6	26	27.9	31.5
	B	43.4	52	61.7	74.2	83.3	99.8
Size	Inch	2 1/2	3	4			
	mm	65	80	100			
Dim. (mm)	A	38.6	43.4	51			
	B	120	141	177			

180

Cross

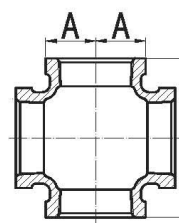

Size	Inch	1/8	1/4	3/8	1/2	3/4	1
	mm	6	8	10	15	20	25
Dim. (mm)	A	19	21	25	28	33	38
	B						
Size	Inch	1 1/4	1 1/2	2	2 1/2	3	4
	mm	32	40	50	65	80	100
Dim. (mm)	A	45	50	58	69	78	96
	B						

180R

Reducing Cross

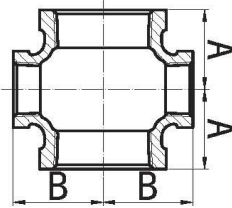

Size	Inch	4X1	4X11/4	4X11/2	4X2	4X21/2
	mm	100X25	100X32	100X40	100X50	100X65
Dim. (mm)	A	56	60	61	70	84
	B	81	84	84	86	92
Size	Inch	11/2X11/2	11/2X3/4	11/2X1	11/2X11/4	2X3/4
	mm	40X15	40X20	40X25	40X32	50X20
Dim. (mm)	A	36	38	42	46	40
	B	42	44	46	48	50

180R

Reducing Cross

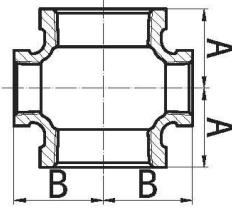

Size	Inch	4X3	3/4X1/2	1X1/2	1X3/4	11/4X1/2
	mm	100X80	20X15	25X15	25X20	32X15
Dim. (mm)	A	82	30	32	35	34
	B	90	31	34	36	38
Size	Inch	2X1	2X11/4	2X11/2	21/2X3/4	21/2X1
	mm	50X25	50X32	50X40	65X20	65X25
Dim. (mm)	A	44	48	52	43	47
	B	52	54	55	57	60

180R

Reducing Cross

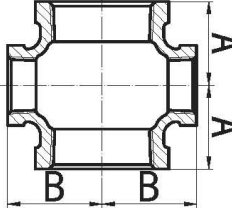

Size	Inch	11/4X3/4	11/4X1	21/2X2	3X3/4	3X1	21/2X11/4
	mm	32X20	32X25	65X50	80X20	80X25	65X32
Dim. (mm)	A	36	40	61	45	51	52
	B	41	42	66	65	67	62
Size	Inch	21/2X11/2	3X11/4	3X11/2	3X2	3X21/2	
	mm	65X40	80X32	80X40	80X50	80X65	
Dim. (mm)	A	55	55	58	64	72	
	B	63	70	71	73	76	

220

Socket

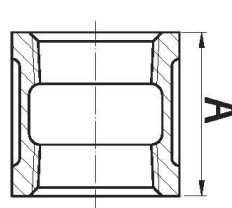

Size	Inch	1/8	1/4	3/8	1/2	3/4	1	11/4
	mm	6	8	10	15	20	25	32
Dim. (mm)	A	25	27	30	36	39	45	50
Size	Inch	11/2	2	21/2	3	4	5	6
	mm	40	50	65	80	100	125	150
Dim. (mm)	A	55	65	74	80	94	95	105

220S

Socket R/L

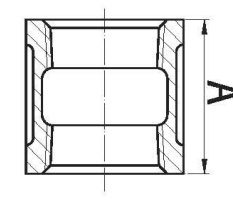

Size	Inch	1/2	3/4	1	11/4	11/2	2
	mm	15	20	25	32	40	50
Dim. (mm)	A	36	39	45	50	55	65
Size	Inch						
	mm						
Dim. (mm)	A						

240

Reducing Socket

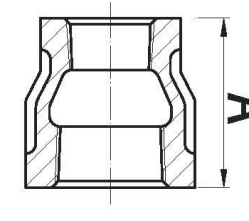

Size	Inch	4X1	4X11/4	4X11/2	4X2	4X21/2
	mm	100X25	100X32	100X40	100X50	100X65
Dim. (mm)	A	94	94	94	94	94
Size	Inch	1/2X1/8	1/2X1/4	1/2X3/8	3/4X1/8	3/4X1/4
	mm	15X6	15X8	15X10	20X6	20X8
Dim. (mm)	A	36	36	36	39	39

240

Reducing Socket

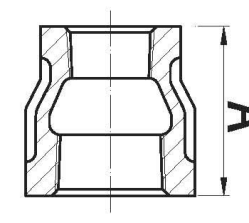

Size	Inch	4X3	3/8X1/8	3/8X1/4	5X4	6X4
	mm	100X80	10X6	10X8	125X100	150X100
Dim. (mm)	A	94	30	30	122	105
Size	Inch	3/4X3/8	3/4X1/2	1X1/4	1X3/8	1X1/2
	mm	20X10	20X15	25X8	25X10	25X15
Dim. (mm)	A	39	39	45	45	45

240

Reducing Socket

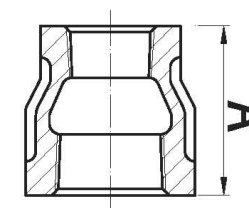

Size	Inch	6X2	6X3	11/4X3/8	11/4X1/2	11/4X3/4
	mm	150X50	150X80	32X10	32X15	32X20
Dim. (mm)	A	105	105	50	50	50
Size	Inch	1X3/4	11/4X1/4	2X1	2X11/4	2X11/2
	mm	25X20	32X8	50X25	50X32	50X40
Dim. (mm)	A	45	50	65	65	65

240

Reducing Socket

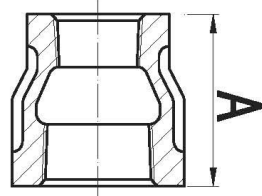

Size	Inch	6X2	6X3	11/4X3/8	11/4X1/2	11/4X3/4	1X3/4
	mm	150X50	150X80	32X10	32X15	32X20	25X20
Dim. (mm)	A	105	105	50	50	50	45
Size	Inch	11/4X1/4	2X1	2X11/4	2X11/2	11/4X1	11/2X11/4
	mm	32X8	50X25	50X32	50X40	32X25	40X8
Dim. (mm)	A	50	65	65	65	50	55

240

Reducing Socket

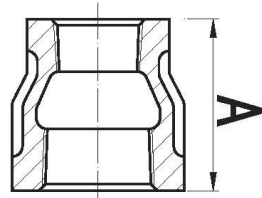

Size	Inch	11/2X3/8	11/2X1/2	11/2X3/4	21/2X1/2	21/2X3/4	21/2X1
	mm	40X10	40X15	40X20	65X15	65X20	65X25
Dim. (mm)	A	55	55	55	74	74	74
Size	Inch	21/2X11/4	21/2X11/2	11/2X1	11/2X11/4	2X1/2	2X3/4
	mm	65X32	65X40	40X25	40X32	50X15	50X20
Dim. (mm)	A	74	74	55	55	65	65

240

Reducing Socket

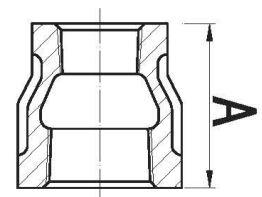

Size	Inch	3X11/4	21/2X2	3X1/2	3X3/4	3X1	3X11/2
	mm	80X32	65X50	80X15	80X20	80X25	80X40
Dim. (mm)	A	80	74	80	80	80	80
Size	Inch	3X2	3X21/2	11/4X11/8			
	mm	80X50	80X65	8X6			
Dim. (mm)	A	80	80	27			

241

Bushing

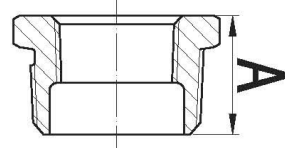

Size	Inch	4X3/4	4X1	4X11/4	4X11/2	4X3
	mm	100X20	100X25	100X32	100X40	100X80
Dim. (mm)	A	51	51	51	51	51
Size	Inch	11/2X3/8	3/4X11/8	3/4X11/4	3/4X3/8	3/4X1/2
	mm	15X10	20X6	20X8	20X10	20X15
Dim. (mm)	A	24	26	26	26	26

241

Bushing

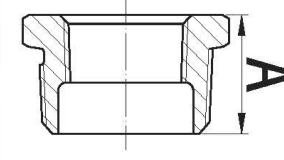
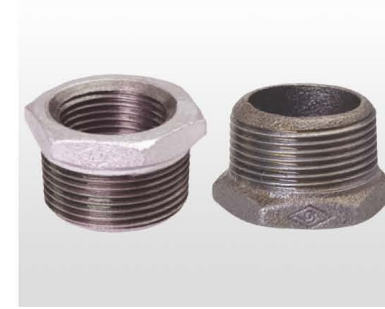

Size	Inch	3/8X1/8	3/8X1/4	5X4	6X5	6X21/2
	mm	10X6	10X8	125X100	150X125	150X65
Dim. (mm)	A	20	20	47	69	69
Size	Inch	1X1/4	1X3/8	1X1/2	1X3/4	11/4X3/8
	mm	25X8	25X10	25X15	25X20	32X10
Dim. (mm)	A	29	29	29	29	31

241

Bushing

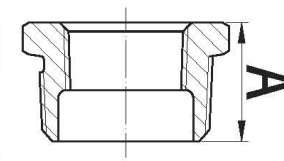

Size	Inch	11/2X1/8	11/2X1/4	11/4X1	11/2X1/4	11/2X3/8
	mm	15X6	15X8	32X25	40X8	40X10
Dim. (mm)	A	24	24	31	31	31
Size	Inch	11/4X1/2	11/4X3/4	21/2X11/2	21/2X2	3X2
	mm	32X15	32X20	65X40	65X50	80X50
Dim. (mm)	A	31	31	40	40	44

241

Bushing

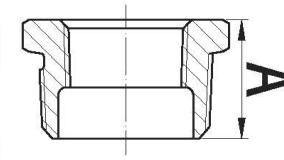

Size	Inch	11/2X1/2	11/2X3/4	11/2X1	11/2X11/4	2X1	3X21/2
	mm	40X15	40X20	40X25	40X32	50X25	80X65
Dim. (mm)	A	31	31	31	31	35	44
Size	Inch	11/4X1/8	2X11/4	2X11/2	21/2X11/2	21/2X3/4	
	mm	8X6	50X32	50X40	65X15	65X20	
Dim. (mm)	A	20	35	35	40	40	

241D

Bushing

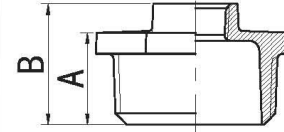

Size	Inch	2X1/2	2X3/4	21/2X1	21/2X11/4	3X11/2
	mm	50X15	50X20	65X25	65X32	80X15
Dim. (mm)	A	35	35	40	40	44
	B	48	48	54	54	59
Size	Inch	6X4	3X3/4	3X1	3X11/4	3X11/2
	mm	150X100	80X20	80X25	80X32	80X40
Dim. (mm)	A	63	44	44	44	44
	B	86	59	59	59	59

241D

Bushing

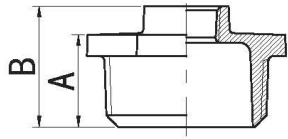

Size	Inch	4X2	4X2 1/2	6X3		
	mm	100X50	100X85	150X80		
Dim. (mm)	A	51	51	63		
	B	69	69	86		
Size	Inch					
	mm					
Dim. (mm)	A					
	B					

245

Reducing Hexagon Nipple

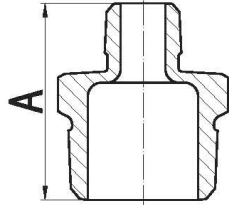

Size	Inch	4X2	4X2 1/2	4X3	3/8X1/4	1/2X1/4
	mm	100X50	100X65	100X80	10X8	15X8
Dim. (mm)	A	87	87	87	38	44
Size	Inch	1 1/4X3/4	1 1/4X1	1 1/2X1/2	1 1/2X3/4	1 1/2X1
	mm	32X20	32X25	40X15	40X20	40X25
Dim. (mm)	A	57	57	59	59	59

245

Reducing Hexagon Nipple

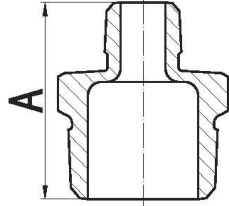

Size	Inch	1/2X3/8	3/4X1/4	3/4X3/8	3/4X1/2	1X1/2
	mm	15X10	20X8	20X10	20X15	25X15
Dim. (mm)	A	44	47	47	47	53
Size	Inch	1 1/2X1 1/4	2X1/2	2X3/4	2X1	2X1 1/4
	mm	40X32	50X15	50X20	50X25	50X32
Dim. (mm)	A	59	68	68	68	68

245

Reducing Hexagon Nipple

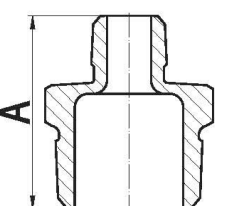

Size	Inch	1X3/4	1 1/4X1/2	2 1/2X1 1/4	2 1/2X1 1/2	2 1/2X2	2X1 1/2
	mm	25X20	32X15	65X32	65X40	65X50	50X40
Dim. (mm)	A	53	57	75	75	75	68
Size	Inch	1/4X1/8	2 1/2X1	3X1 1/2	3X2	3X2 1/2	
	mm	8X6	65X25	80X40	80X50	80X65	
Dim. (mm)	A	31	75	83	83	83	

246

Reducing Socket M/F

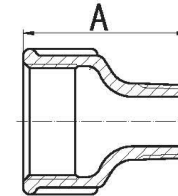

Size	Inch	3/8X1/4	1/2X1/4	1/2X3/8	3/4X3/8	3/4X1/2
	mm	10X8	15X8	15X10	20X10	20X15
Dim. (mm)	A	35	43	43	48	48
Size	Inch	1 1/2X1 1/4	2X1	2X1 1/4	2X1 1/2	1X1/2
	mm	40X32	50X25	50X32	50X40	25X15
Dim. (mm)	A	63	70	70	70	55

246

Reducing Socket M/F

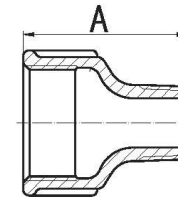

Size	Inch	1X3/4	1 1/4X1/2	1 1/4X3/4	1 1/4X1	1 1/2X3/4
	mm	25X20	32X15	32X20	32X25	40X20
Dim. (mm)	A	55	60	60	60	63
Size	Inch	1 1/2X1				
	mm	40X25				
Dim. (mm)	A	63				

270

Parallel Thread Socket

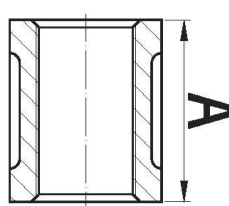

Size	Inch	1/8	1/4	3/8	1/2	3/4	1	1 1/4
	mm	6	8	10	15	20	25	32
Dim. (mm)	A	25	27	30	36	39	45	50
Size	Inch	6	1 1/2	2	2 1/2	3	4	
	mm	150	40	50	65	80	100	
Dim. (mm)	A	120	55	65	74	80	94	

280

Hexagon Nipple

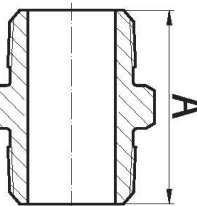

Size	Inch	1/8	1/4	3/8	1/2	3/4	1	1 1/4
	mm	6	8	10	15	20	25	32
Dim. (mm)	A	29	36	38	44	47	53	57
Size	Inch	5	6	1 1/2	2	2 1/2	3	4
	mm	125	150	40	50	65	80	100
Dim. (mm)	A	103	110	59	68	75	83	95

291

Plain Plug

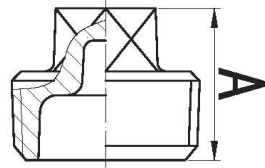

Size	Inch	1/8	1/4	3/8	3/4	1	1 1/4	1 1/2
	mm	6	8	10	20	25	32	40
Dim. (mm)	A Min	11	14	15	20	23	29	30
Size	Inch	2	2 1/2	3	4	6		
	mm	50	65	80	100	150		
Dim. (mm)	A Min	36	39	44	58	71.5		

291LM

Plain Plug

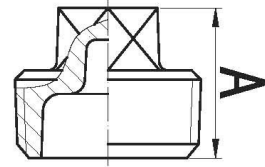

Size	Inch	1/2	3/4	1	1 1/4	1 1/2	2
	mm	15	20	25	32	40	50
Dim. (mm)	A	25	28.5	32.5	35.1	37.6	40.1
Size	Inch	2 1/2	3	4			
	mm	65	80	100			
Dim. (mm)	A	46	50	64.5			

291N

Countersunk Plug

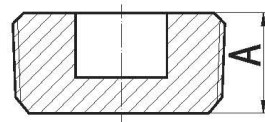

Size	Inch	1/2	3/4	1	1 1/4	1 1/2	2
	mm	15	20	25	32	40	50
Dim. (mm)	A Min	14.2	16	19	20.3	21.1	22.4
Size	Inch	2 1/2	3				
	mm	65	80				
Dim. (mm)	A Min	27.2	38.7				

291S

Solid Plug

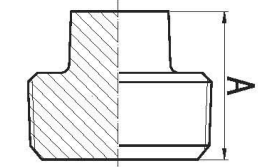

Size	Inch	1/4	3/8	1/2	3/4	1	1 1/4
	mm	8	10	15	20	25	32
Dim. (mm)	A Min	14	15	18	20	23	29
Size	Inch	1 1/2	2	2 1/2	3		
	mm	40	50	65	80		
Dim. (mm)	A Min	30	36	39	44		

300

Cap

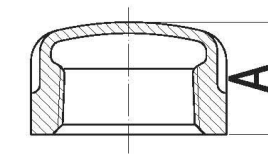

Size	Inch	1/8	1/4	3/8	1/2	3/4	1	1 1/4
	mm	6	8	10	15	20	25	32
Dim. (mm)	A Min	13	15	17	19	22	24	27
Size	Inch	1 1/2	2	2 1/2	3	4	5	6
	mm	40	50	65	80	100	125	150
Dim. (mm)	A Min	27	32	35	38	45	54	61

310

Locknut

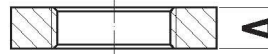

Size	Inch	1/4	3/8	1/2	3/4	1	1 1/4
	mm	8	10	15	20	25	32
Dim. (mm)	A	6	7	8	9	10	11
Size	Inch	1 1/2	2	2 1/2	3	4	
	mm	40	50	65	80	100	
Dim. (mm)	A	12	13	16	19	23	

312

Backnut

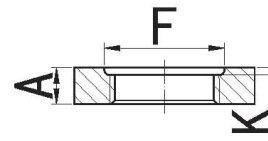
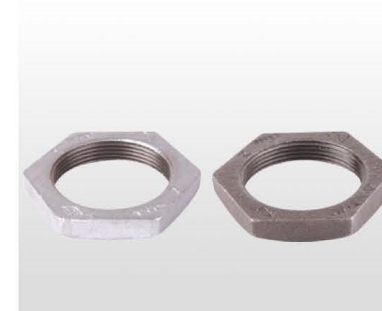

Size	Inch	1/2	3/4	1	1 1/4	1 1/2	2	4
	mm	15	20	25	32	40	50	100
Dim. (mm)	A Min	7.9	8.6	9.7	10.7	11.9	13.5	20.3
	F Min	24.6	31.2	38.1	47.2	53.9	66.8	127
	K	1.5	1.5	1.5	1.5	1.5	2.3	3.3

321-4

Flange Bs4504

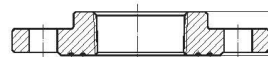

Size	Inch	1 1/4	1 1/2	2	2 1/2	3	4
	mm	32	40	50	65	80	100
Dim. (mm)	A	23	23	28	35	38	38
Size	Inch	6					
	mm	150					
Dim. (mm)	A	48					

321-6

Flange 1600/4

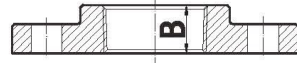

Size	Inch	1 1/4	1 1/2	2	2 1/2	3	4
	mm	32	40	50	65	80	100
Dim. (mm)	B	20	20	22	26	28	34
Size	Inch	6					
	mm	150					
Dim. (mm)	B	40					

321-H

Flange

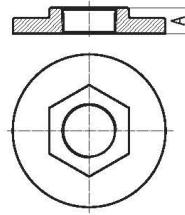

Size	Inch	1/2	3/4	1	1 1/4	1 1/2	2
	mm	15	20	25	32	40	50
Dim. (mm)	A	15	16	19	21	21	26
Size	Inch	2 1/2	3	4			
	mm	65	80	100			
Dim. (mm)	A	30	33	39			

321P

Flange

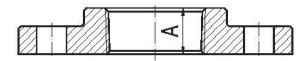

Size	Inch	1/2	3/4	1	1 1/4	1 1/2	2
	mm	15	20	25	32	40	50
Dim. (mm)	A	15	16	19	21	21	26
Size	Inch	2 1/2	3	4	5	6	
	mm	65	80	100	125	150	
Dim. (mm)	A	30	33	39	40	40	

321PW

Flange

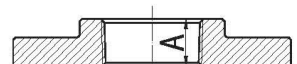

Size	Inch	1/2	3/4	1	1 1/4	1 1/2	2
	mm	15	20	25	32	40	50
Dim. (mm)	A	15	16	19	21	21	26
Size	Inch	2 1/2	3	4	5	6	
	mm	65	80	100	125	150	
Dim. (mm)	A	30	33	39	40	40	

321TD

Flange



Size	Inch	1	1 1/4	1 1/2	2	2 1/2	3
	mm	25	32	40	50	65	80
Dim. (mm)	A	16	17.4	23	25	25	26.8
Size	Inch	4	6				
	mm	100	150				
Dim. (mm)	A	31.5	35				

330

Flat Seat Union

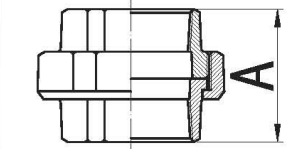

Size	Inch	1/8	1/4	3/8	1/2	3/4	1	1 1/4
	mm	6	8	10	15	20	25	32
Dim. (mm)	A	38	42	45	48	52	58	65
Size	Inch	1 1/2	2	2 1/2	3	4	6	
	mm	40	50	65	80	100	150	
Dim. (mm)	A	70	78	85	95	100	144	

330D

Flat Seat Union

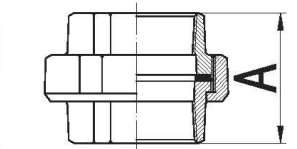

Size	Inch	1/8	1/4	3/8	1/2	3/4	1	1 1/4
	mm	6	8	10	15	20	25	32
Dim. (mm)	A	38	42	45	48	52	58	65
Size	Inch	1 1/2	2	2 1/2	3	4	6	
	mm	40	50	65	80	100	150	
Dim. (mm)	A	70	78	85	95	100	144	

331

Flat Seat Union M/F

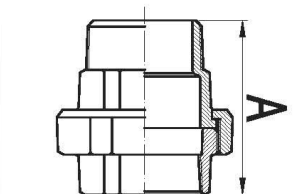

Size	Inch	1/2	3/4	1	1 1/4	1 1/2	2
	mm	15	20	25	32	40	50
Dim. (mm)	A	66	72	80	90	95	106
Size	Inch	2 1/2	3	4			
	mm	65	80	100			
Dim. (mm)	A	118	130	133			

340

Conical Joint Union

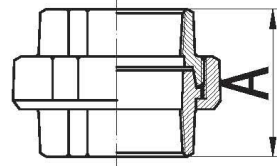

Size	Inch	1/8	1/4	3/8	1/2	3/4	1
	mm	6	8	10	15	20	25
Dim. (mm)	A	38	42	45	48	52	58
Size	Inch	1 1/4	1 1/2	2	2 1/2	3	4
	mm	32	40	50	65	80	100
Dim. (mm)	A	65	70	78	85	95	110

340Q

Deflection Union

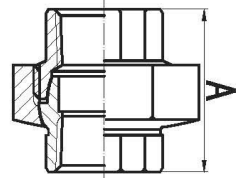

Size	Inch	1/2	3/4	1	1 1/4	1 1/2	2
	mm	15	20	25	32	40	50
Dim. (mm)	A	46	49	55	64	74.5	83
Size	Inch						
	mm						
Dim. (mm)	A						

341

Conical Joint Union M/F

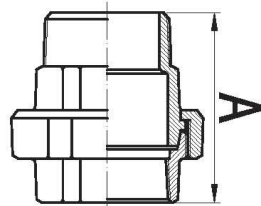

Size	Inch	1/4	3/8	1/2	3/4	1	1 1/4
	mm	8	10	15	20	25	32
Dim. (mm)	A	55	55	66	72	80	90
Size	Inch	1 1/2	2	2 1/2	3	4	
	mm	40	50	65	80	100	
Dim. (mm)	A	95	106	118	130	133	

342

Conical Joint Union

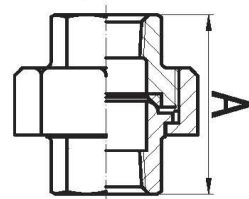

Size	Inch	1/8	1/4	3/8	1/2	3/4	1	1 1/4
	mm	6	8	10	15	20	25	32
Dim. (mm)	A Min	32	36.5	41	43.5	49.5	52.5	57.5
Size	Inch	1 1/2	2	2 1/2	3	4	6	
	mm	40	50	65	80	100	150	
Dim. (mm)	A Min	61	70	82	89	98	147	

342A

Double Bronze Navy Union

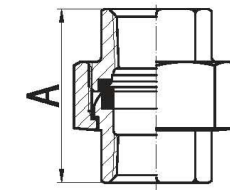

Size	Inch	1/2	3/4	1	1 1/4	1 1/2	2
	mm	15	20	25	32	40	50
Dim. (mm)	A	48	52	58	65	70	78
Size	Inch						
	mm						
Dim. (mm)	A						

526

Long Adapter M/F

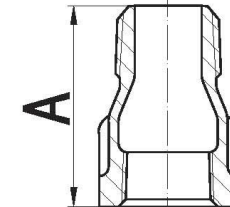

Size	Inch	1/2X30	1/2X40	1/2X50	1/2X60	1/2X100
	mm	15X30	15X40	15X50	15X60	15X100
Dim. (mm)	A	30	40	50	60	100
Size	Inch	1/2X30	1/2X40	1/2X50	1/2X60	1/2X100
	mm	15X30	15X40	15X50	15X60	15X100
Dim. (mm)	A	30	40	50	60	100

529A

Long Extension Piece

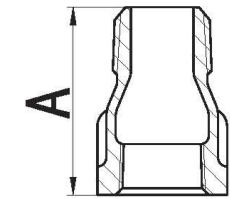

Size	Inch	1/4	3/8	1/2	3/4	1	1 1/4
	mm	8	10	15	20	25	32
Dim. (mm)	A	33	35	43	48	55	60
Size	Inch	1 1/2	2	2 1/2	3	4	
	mm	40	50	65	80	100	
Dim. (mm)	A	61.5	68	76	83	97	

529X

Short Extension Piece

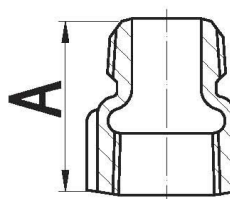

Size	Inch	1/2					
	mm	15					
Dim. (mm)	A	32					
Size	Inch						
	mm						
Dim. (mm)	A						

1221

Side Outlet Elbow

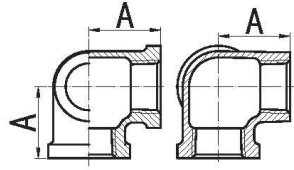

Size	Inch	1/2	3/4	1	1 1/2	2	
	mm	15	20	25	40	50	
Dim. (mm)	A	28	33	38	50	58	
Size	Inch						
	mm						
Dim. (mm)	A						

1223

Side Outlet Tee

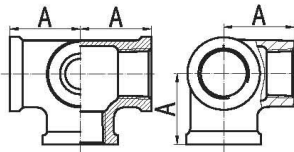

Size	Inch	1/2	3/4	1	1 1/4		
	mm	15	20	25	32		
Dim. (mm)	A	28	33	38	45		
Size	Inch						
	mm						
Dim. (mm)	A						

1224

Side Outlet Cross

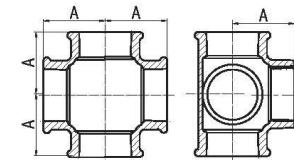

Size	Inch	1 1/4	1 1/2				
	mm	32	40				
Dim. (mm)	A	45	50				
Size	Inch						
	mm						
Dim. (mm)	A						

LAA

Coupling Luck F/F

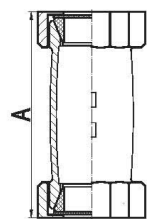

Size	Inch	1/2	3/4	1	1 1/4	1 1/2	2
	mm	15	20	25	32	40	50
Dim. (mm)	A	95	104	110	114	122	129
Size	Inch						
	mm						
Dim. (mm)	A						

LAF

Coupling Luck M/F

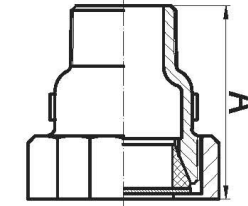

Size	Inch	1/2	3/4	1	1 1/4	1 1/2	2
	mm	15	20	25	32	40	50
Dim. (mm)	A	59	63	65	69	71	79
Size	Inch						
	mm						
Dim. (mm)	A						

LCC

Long Compression Coupling

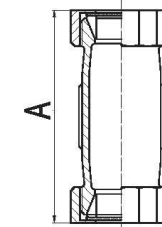

Size	Inch	1/2	3/4	1	1 1/4	1 1/2	2
	mm	15	20	25	32	40	50
Dim. (mm)	A	93	101	109	114	118	121
Size	Inch	2 1/2	3	4			
	mm	65	80	100			
Dim. (mm)	A	137	145	155			

SCC

Short Compression Coupling

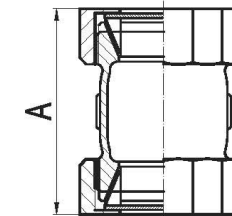

Size	Inch	1/2	3/4	1	1 1/4	1 1/2	2
	mm	15	20	25	32	40	50
Dim. (mm)	A	62	69	73	79	79	84
Size	Inch	2 1/2	3				
	mm	65	80				
Dim. (mm)	A	100	110				

TCC

Compression Tee

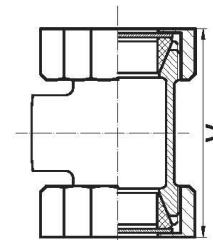

Size	Inch	1/2	3/4				
	mm	15	20				
Dim. (mm)	A	80	88				
Size	Inch						
	mm						
Dim. (mm)	A						

Malleable Iron Collar Fittings

BS Standard



90

Elbow, 90°

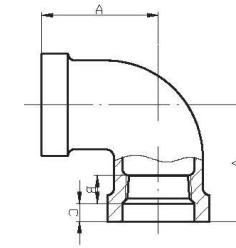

Size/规格	Inch	1/2	3/4	1	1 1/4	1 1/2	2
	mm	15	20	25	32	40	50
Dim./尺寸 (mm)	A	35.5	41	47	55	60	69
	B	11	13	15	17	18	20
	C	7	8	9	10	10	11
Size/规格	Inch	3	4	6			
	mm	80	100	150			
Dim./尺寸 (mm)	A	91	110	145			
	B	25.5	28.5	33			
	C	13	14	15			

90R

Reducing Elbow, 90°

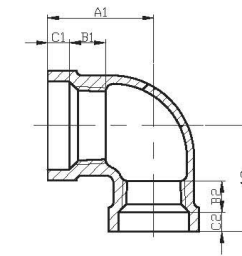

Size/规格	Inch	3/4X1/2	1X3/4	1 1/4X1		
	mm	20X15	25X20	32X25		
Dim./尺寸 (mm)	A1	38	44	50		
	B1	13	15	17		
	C1	8	9	10		
	A2	38	44	51		
	B2	11	13	15		
	C2	7	8	9		

92

Street Elbow, 90°

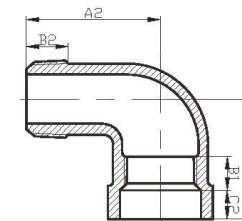

Size/规格	Inch	1/2	3/4	1	1 1/4	1 1/2	2
	mm	15	20	25	32	40	50
Dim./尺寸 (mm)	A1	35	41	47	55	60	69
	B1	11	13	15	17	18	20
	C1	7	8	9	10	10	11
	A2	41	48	54	62	68	82.5
	B2	14	15	18	19	20	22

120

Elbow, 45°

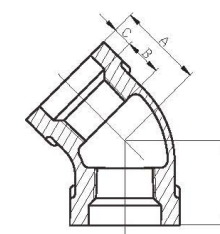

Size/规格	Inch	1/2	3/4	1	1 1/4	1 1/2	2
	mm	15	20	25	32	40	50
Dim./尺寸 (mm)	A	28	33	38	44	46	53
	B	11	13	15	17	18	20
	C	7	8	9	10	10	11
Size/规格	Inch	3	4	6			
	mm	80	100	150			
Dim./尺寸 (mm)	A	67	79	97			
	B	25.5	28.5	33			
	C	13	14	15			

130

Tee

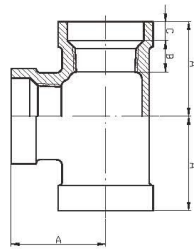

Size/规格	Inch	1/2	3/4	1	1 1/4	1 1/2	2
	mm	15	20	25	32	40	50
Dim./尺寸 (mm)	A	35.5	41	47	55	60	69
	B	11	13	15	17	18	20
	C	7	8	9	10	10	11
Size/规格	Inch	3	4	6			
	mm	80	100	150			
Dim./尺寸 (mm)	A	91	110	145			
	B	25.5	28.5	33			
	C	13	14	15			

130R

Reducing Tee

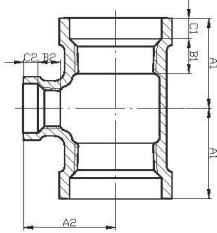

Size/规格	Inch	3/4X1/2	1X1/2	1X3/4	1 1/4X1/2	1 1/4X3/4
	mm	20X15	25X15	25X20	32X15	32X20
Dim./尺寸 (mm)	A1	38	41	43.5	44	46
	B1	13	15	15	17	17
	C1	8	9	9	10	10
	A2	38	41	44.5	45	49
	B2	11	11	13	11	13
	C2	7	7	8	7	8

130R

Reducing Tee

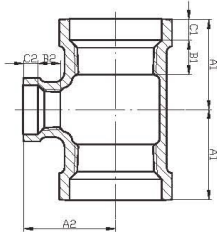

Size/规格	Inch	1 1/4X1	1 1/2X1/2	1 1/2X3/4	1 1/2X1	1 1/2X1 1/4
	mm	32X25	40X15	40X20	40X25	40X32
Dim./尺寸 (mm)	A1	50	46	48.5	52	56
	B1	17	18	18	18	18
	C1	10	10	10	10	10
	A2	51	49	52.5	54.5	57.5
	B2	15	11	13	15	17
	C2	9	7	8	9	10

130R

Reducing Tee

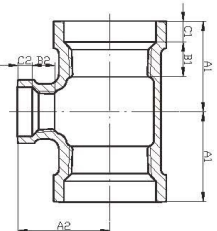

Size/规格	Inch	2X1/2	2X3/4	2X1	2X1 1/4	2X1 1/2
	mm	50X15	50X20	50X25	50X32	50X40
Dim./尺寸 (mm)	A1	49	51.5	54.5	59	62
	B1	20	20	20	20	20
	C1	11	11	11	11	11
	A2	55	58	60	63	64.5
	B2	11	13	15	17	18
	C2	7	8	9	10	10

130R

Reducing Tee

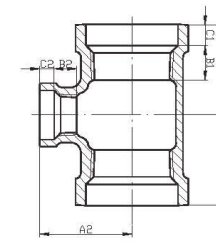

Size/规格	Inch	3X3/4	3X1	3X1 1/4	3X2	4X3/4
	mm	80X20	80X25	80X32	80X50	100X20
Dim./尺寸 (mm)	A1	60	63	68	77	68
	B1	25.5	25.5	25.5	25.5	28.5
	C1	13	13	13	13	14
	A2	74	76	79	84	88
	B2	13	15	17	20	13
	C2	8	9	10	11	8

130R

Reducing Tee

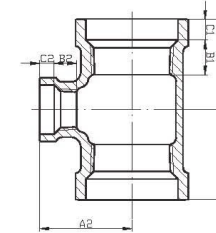

Size/规格	Inch	4X1	4X1 1/4	4X2	4X3	6X3
	mm	100X25	100X32	100X50	100X80	150X80
Dim./尺寸 (mm)	A1	71	75	83.5	97	107.5
	B1	28.5	28.5	28.5	28.5	33
	C1	14	14	14	14	15
	A2	95	96	97.5	104	133.5
	B2	15	17	20	25.5	25.5
	C2	9	10	11	13	13

130R

Reducing Tee

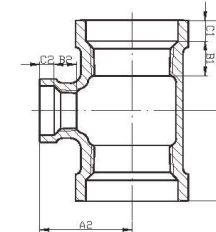

Size/规格	Inch	6X4	3/4X1/2X1/2			
	mm	150X100	20X15X15			
Dim./尺寸 (mm)	A1	119.5	38.5			
	B1	33	13			
	C1	15	8			
	A2	139.5	38			
	B2	28.5	11			
	C2	14	7			
A3			35.5			

180R

Reducing Cross

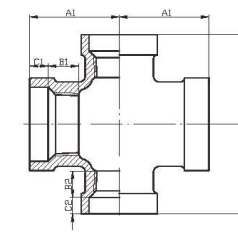

Size/规格	Inch	1X1/2	1 1/4X3/4	1 1/4X1	1 1/2X1/2	1 1/2X3/4
	mm	25X15	32X20	32X25	40X15	40X20
Dim./尺寸 (mm)	A1	41	46	50	46	48
	B1	15	17	17	18	18
	C1	9	10	10	10	10
	A2	41	49	51	49	52
	B2	11	13	15	11	13
	C2	7	8	9	7	8

180R

Reducing Cross

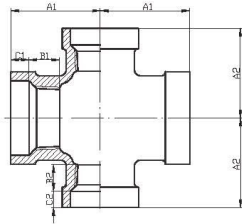

Size/规格	Inch	1 1/2X1	2X3/4	2X1	3X3/4	3X1
	mm	40X25	50X20	50X25	80X20	80X25
Dim./尺寸 (mm)	A1	52	51.5	54.5	60	63
	B1	18	20	20	25.5	25.5
	C1	10	11	11	13	13
	A2	54.5	58	60	74	76
	B2	15	13	15	13	15
	C2	9	8	9	8	9

180R

Reducing Cross

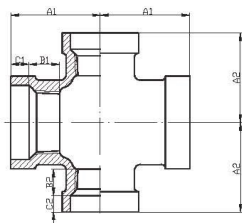

Size/规格	Inch	3X1 1/4	4X3/4	4X1	4X1 1/4	6X3
	mm	80X32	100X20	100X25	100X32	150X30
Dim./尺寸 (mm)	A1	68	68	71	75	107.5
	B1	25.5	28.5	28.5	28.5	33
	C1	13	14	14	14	15
	A2	79	88	90	96	133.5
	B2	17	13	15	17	25.5
	C2	10	8	9	10	13

220

Socket

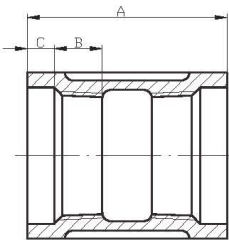

Size/规格	Inch	1/2	3/4	1	1 1/4	1 1/2
	mm	15	20	25	32	40
Dim./尺寸 (mm)	A	48	54	60	69	74.5
	B	11	13	15	17	18
	C	7	8	9	10	10
Size/规格	Inch	2	3	4	6	
	mm	50	80	100	150	
Dim./尺寸 (mm)	A	86	106.5	121.5	146.5	
	B	20	25.5	28.5	33	
	C	11	13	14	15	

241

Bushing

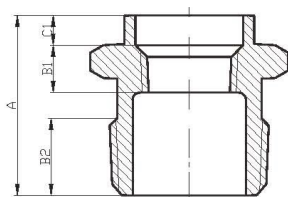

Size/规格	Inch	3/4X1/2	1X1/2	1X3/4	1 1/4X3/4	1 1/4X1
	mm	20X15	25X15	25X20	32X20	32X25
Dim./尺寸 (mm)	A	38	42	42	49	50
	B1	11	11	14.5	13	17
	C1	7	7	7	8	9
	B2	14.5	17	17	19	19
Size/规格	Inch	1 1/2X3/4	1 1/2X1	1 1/2X1 1/4	2X3/4	2X1
	mm	40X20	40X25	40X32	50X20	50X25
Dim./尺寸 (mm)	A	49	50	51	56	57
	B1	13	15	19	13	15
	C1	8	9	10	8	9
	B2	19	19	19	22	22

241

Bushing

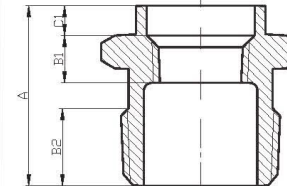

Size/规格	Inch	2X1 1/4	2X1 1/2	3X1	3X1 1/2	3X2
	mm	50X32	50X40	80X25	80X40	80X50
Dim./尺寸 (mm)	A	58	58	66	67	68
	B1	17	18	15	18	20
	C1	10	10	9	10	11
	B2	22	22	31	31	31
Size/规格	Inch	4X3	6X3	6X4		
	mm	100X80	150X80	150X100		
Dim./尺寸 (mm)	A	78	93	94		
	B1	25.5	25.5	28.5		
	C1	13	13	14		
	B2	36	41	41		

280

Hexagon Nipple

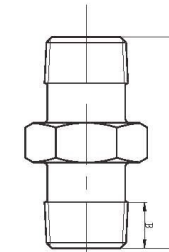

Size/规格	Inch	1/2	3/4	1	1 1/4	1 1/2
	mm	15	20	25	32	40
Dim./尺寸 (mm)	A	58	64	71	80	81
	B	13	14	16	19	19
Size/规格	Inch	2	3	4	6	
	mm	50	80	100	150	
Dim./尺寸 (mm)	A	94	110	130	146	
	B	23	29	35	40	

291

Plug

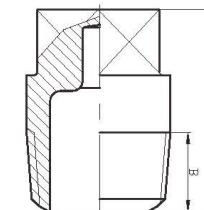

Size/规格	Inch	1/2	3/4	1	1 1/4	1 1/2
	mm	15	20	25	32	40
Dim./尺寸 (mm)	A	30	34.5	40	44.5	46.5
	B	15	16.5	19	21.5	21.5
Size/规格	Inch	2	3	4	6	
	mm	50	80	100	150	
Dim./尺寸 (mm)	A	51.5	65	76	87.5	
	B	25.5	33	39	43.5	

300

Cap

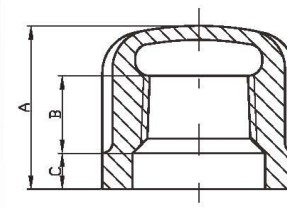

Size/规格	Inch	1/2	3/4	1	1 1/4	1 1/2
	mm	15	20	25	32	40
Dim./尺寸 (mm)	A	28	33	38	41	44
	B	11	13	15	17	18
	C	7	8	9	10	10
Size/规格	Inch	2	3	4		
	mm	50	80	100		
Dim./尺寸 (mm)	A	49	59	70		
	B	20	25.5	28.5		
	C	11	13	14		

529A

Long Extension Piece

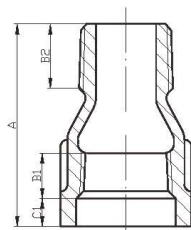

Size/规格	inch	1/2	3/4	1		
	mm	15	20	25		
Dim./尺寸 (mm)	A	50.5	58	66		
	B1	11	13	15		
	C1	7	8	9		
	B2	15	18	20		

Malleable Iron Plain End Fittings

BS Standard



90
Elbow, 90°



130
Tee



130R
Reducing Tee



220
Socket



280
Hexagon Nipple



291
Plug



291LM
Plug



330
Flat Seat Union

90

Elbow, 90°

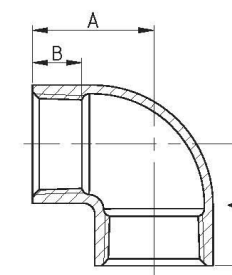

Size/规格	Inch	1/2	3/4	1		
	mm	15	20	25		
Dim./尺寸 (mm)	A	27	32	38		
	B	11	13	15		
Size/规格	Inch					
	mm					
Dim./尺寸 (mm)	A					
	B					

130

Tee

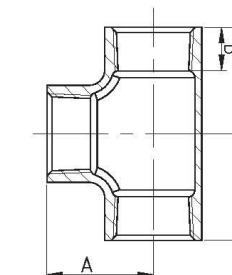

Size/规格	Inch	1/2	3/4	1		
	mm	15	20	25		
Dim./尺寸 (mm)	A	27	32	38		
	B	11	13	15		
Size/规格	Inch					
	mm					
Dim./尺寸 (mm)	A					
	B					

130R

Reducing Tee

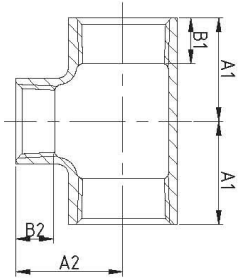

Size/规格	Inch	3/4X1/2	1X3/4			
	mm	20X15	25X20			
Dim./尺寸 (mm)	A1	29.5	31.5			
	B1	13	15			
	A2	30.5	33			
	B2	11	13			

220

Socket

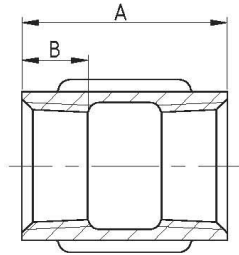

Size/规格	Inch	1/2	3/4	1	1 1/2	
	mm	15	20	25	40	
Dim./尺寸 (mm)	A	34	37	40	44	
	B	11	13	15	18	
Size/规格	Inch					
	mm					
Dim./尺寸 (mm)	A					
	B					

280

Hexagon Nipple

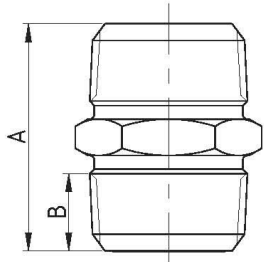

Size/规格	Inch	3/4	1			
	mm	20	25			
Dim./尺寸 (mm)	A	44	50			
	B	15	18			
Size/规格	Inch					
	mm					
Dim./尺寸 (mm)	A					
	B					

291

Plug

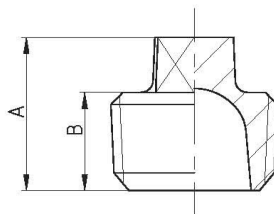

Size/规格	Inch	1/2	3/4	1		
	mm	15	20	25		
Dim./尺寸 (mm)	A	19.5	21	24		
	B	12.5	14	16.5		
Size/规格	Inch					
	mm					
Dim./尺寸 (mm)	A					
	B					

291LM

Plug

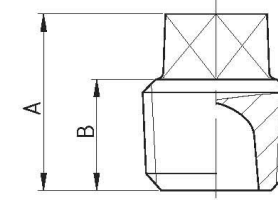

Size/规格	Inch	1/2				
	mm	15				
Dim./尺寸 (mm)	A	25				
	B	15				
Size/规格	Inch					
	mm					
Dim./尺寸 (mm)	A					
	B					

330

Flat Seat Union

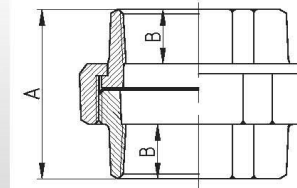

Size/规格	Inch	3/4	1			
	mm	20	25			
Dim./尺寸 (mm)	A	43	45.5			
	B	13	15			
Size/规格	Inch					
	mm					
Dim./尺寸 (mm)	A					
	B					

Basic Dimension for British and Din Standard Pipe Threads

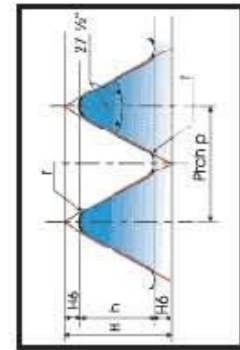

Fig 1 - Parallel thread
 $H = 0.960491 P$
 $h = 0.640327 P$
 $r = 0.137329 P$

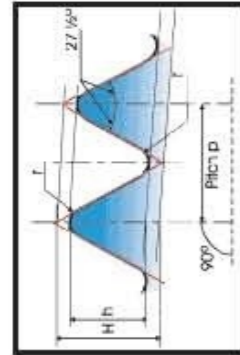
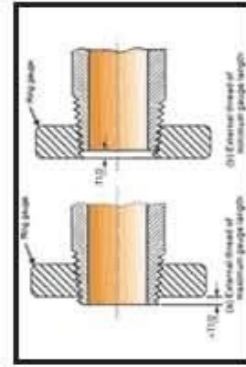

Fig 2 - Taper thread
 $H = 0.960257 P$
 $h = 0.640327 P$
 $r = 0.137278 P$



(a) External thread of maximum gauge length.
 (b) External thread of minimum gauge length.

International Standard ISO 7/1, Pipe Threads Dimensions

Designation: Number of threads in 25.4 mm	Dimensions in millimeters															
	2	3	4	5	6	7	8	9	10	11	12	13	14	15	16	17
	Pitch P		Height of thread h	Major (gauge diameter) d		Minor d1		Effective diameter d2	Gauge Length (external thread)		Tolerance ±1/2		Minimum	Tolerance ±1/2	Length of useful external thread not less than	
1.6	18	0.907	0.381	9.753	9.447	8.545	4	0.9	1	4.9	3.1	1.1			1.1	6.3
1.4	19	1.337	0.834	13.137	12.901	11.443	4	1.3	1	7.3	4.7	1.7	1.7	9.7	11	8.4
3/8	19	1.337	0.834	14.402	13.901	12.591	4	1.3	1	7.7	5.1	1.7	1.7	10.1	11.4	8.8
1/2	14	1.814	1.142	20.915	19.798	18.61	8.2	1.8	1	10	6.4	2.3	2.3	13.2	15	11.4
3/4	14	1.814	1.142	24.441	23.799	21.117	9.5	1.8	1	10	7.7	2.3	2.3	14.5	16.3	12.7
1	11	2.309	1.479	33.249	31.77	30.291	10.4	2.3	1	13.7	8.1	2.9	2.9	16.8	19.1	14.5
1.1/4	11	2.309	1.479	41.91	40.331	38.992	12.7	2.3	1	15	10.4	2.9	2.9	19.1	21.4	16.8
1.1/2	11	2.309	1.479	47.903	46.24	44.843	12.7	2.3	1	15	10.4	2.9	2.9	19.1	21.4	16.8
2	11	2.309	1.479	59.414	58.135	56.61	13.9	2.3	1	18.2	13.4	3.3	3.3	23	25.7	21.1
2 1/2	11	2.309	1.479	75.184	73.705	72.21	17.3	2.3	1	21	14	3.3	3.3	26.7	30.2	23.2
3	11	2.309	1.479	87.884	86.405	84.91	20.4	2.3	1	24.1	17.1	3.3	3.3	29.8	33.3	25.3
4	11	2.309	1.479	113.03	111.551	110.072	25.4	2.3	1	31.9	21.9	3.3	3.3	35.8	39.3	31.3
5	11	2.309	1.479	138.43	136.951	135.472	28.4	2.3	1	35.1	23.1	3.3	3.3	40.1	43.4	34.4
6	11	2.309	1.479	163.83	162.351	160.872	31.4	2.3	1	38.1	25.1	3.3	3.3	43.1	46.4	37.4

Note: This information is selected from the International Standard ISO 7/1:2000: Pipe threads where pressure-tight joints. Table Table 1

Technical Standard For Malleable Steel Pipe Fitting

1) Product standards

BS EN 10242:1995, DIN EN 10242:1995
 ASME B16.3-2016, ASME B16.14-2013, ASME B16.39-2014

2) Material

BS EN 1562, DIN EN 1562, EN-GJMB-350-10
 ASTM A197/A197M-2015, ASTM A47/A47M-2014

3) Thread

ISO 7-1:1994 (BS/DIN)
 ANSI/ASME B1.20.1 (NPT)

4) Chemical and Mechanical Properties

CHEMICAL PROPERTIES					PHYSICAL PROPERTIES	
C %	Si %	Mn %	P %	S %	TENSILE STRENGTH	ELONGATION
2.4-2.9	1.4-1.9	0.40-0.5	<0.1	<0.2	>=350 Mpa	>=10%

HARDNESS: <150HB

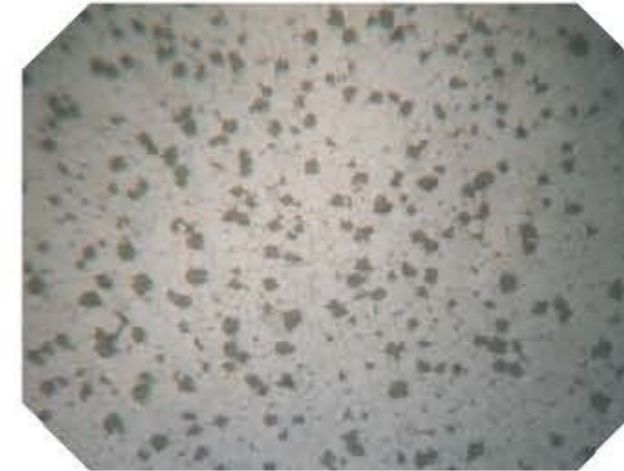

5) Dimensions

Fittings Size (Inch)	1/8	1/4	3/8	1/2	3/4	1	1-1/4
DN (mm)	6	8	10	15	20	25	32

Fittings Size (Inch)	1-1/2	2	2-1/2	3	4	5	6
DN (mm)	40	50	65	80	100	125	150

6) Pressure-Temperature Ratings

Temperature, °C	Class 150, psig	Class 300, psig		
		Size	Size	Size
-29 to 00	300	1/4-1	1/4-2	2-1/2-3
100	205	1/8-5	1/2-5	9-10
125	225	1/2-5	1-10	8-5
150	185	1/8-5	1/2-5	7-5
175	150 Note (1)	1/2-5	9-10	8-5
200	20 to 150	8-5	7-5	8-5
225	20 to 150	7-5	6-10	4-5
250	20 to 150	5-10	4-5	3-5
275	20 to 150	3-10	3-10	3-10

7) Tolerances

BS&DIN

Dimension	Tolerance (mm)	Tolerance (in)
≤30	±1.5	±0.06
30-50	±2.0	±0.08
50-75	±2.5	±0.10
75-100	±3	±0.12
100-150	±3.5	±0.14
150-200	±4	±0.16

American

NPS	Tolerance (mm)	Tolerance (in)
1/8	±0.70	±0.03
1/4	±1	±0.04
3/8	±1.27	±0.05
1/2, 3/4	±1.52	±0.06
1, 1-1/4	±1.77	±0.07
1-1/2, 2	±2	±0.08
2-1/2, 3, 3-1/2	±2.54	±0.10
4, 5	±3	±0.12
6	±3.55	±0.14